

DEORE LX Brake Lever

BL-M585 For Disc Brake

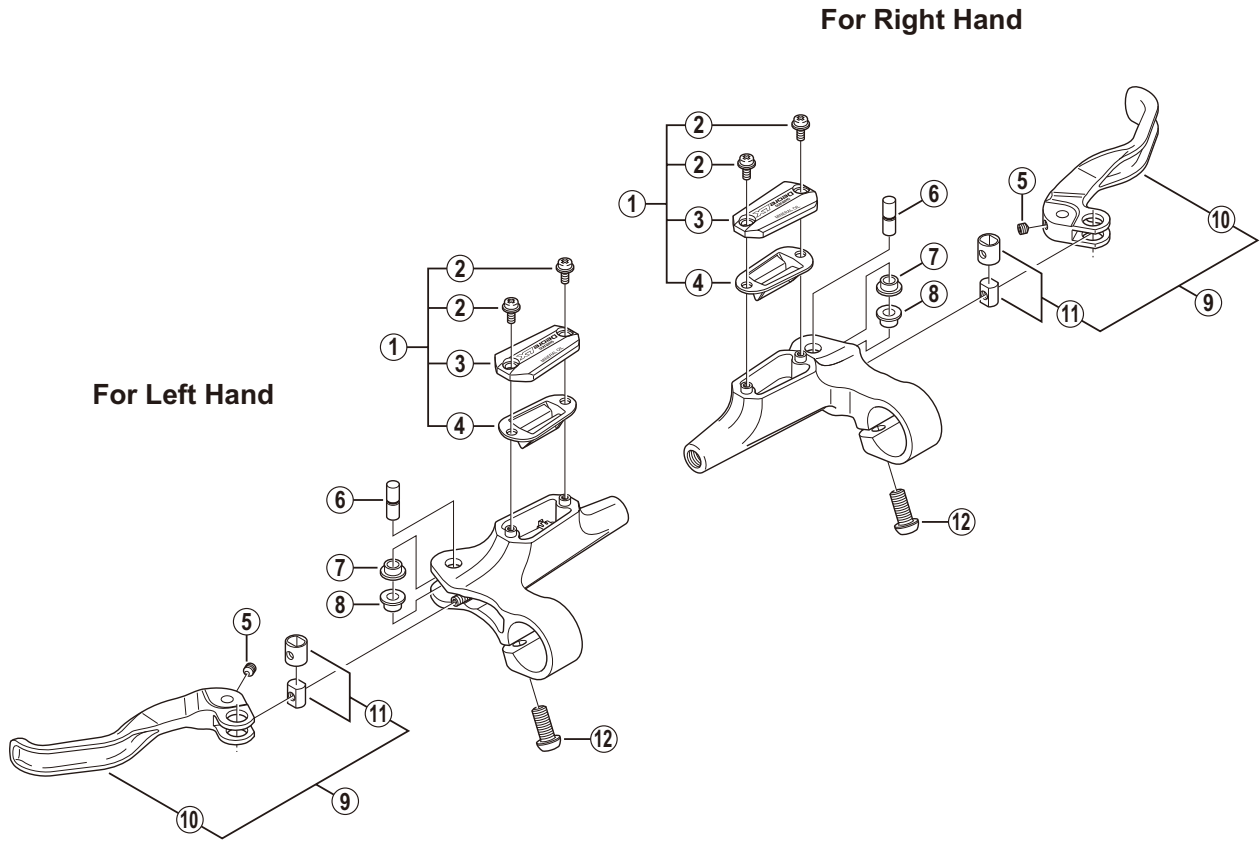

ITEM NO.	SHIMANO CODE NO.	DESCRIPTION
1	Y-8T1 98010	R.H. Lid Unit
	Y-8T1 98020	L.H. Lid Unit
2	Y-8SY 24000	Lid Fixing Screw
3	Y-8S4 07060	R.H. Lid
	Y-8S4 07160	L.H. Lid
4	Y-8S1 06000	Diaphragm
5	Y-8SZ 07000	Lever Axle Fixing Bolt
6	Y-8SZ 06000	Lever Axle
7	Y-8SZ 03000	Lever Axle Bush A
8	Y-8SZ 04000	Lever Axle Bush B
9	Y-8T1 98030	Lever Unit
10	Y-8SZ 05200	Lever Member
11	Y-6JK 98070	Reach Adjusting Boss & Sleeve
12	Y-8SB 10000	Clamp Bolt (M6 x 14.8)

0408-2410

Specifications are subject to change without notice.

SHIMANO