

## General Safety Information

**⚠ WARNING** – To avoid serious injuries:

- Be sure to attach reflectors to the bicycle when riding at night. Do not continue riding the bicycle if the reflectors are dirty or damaged, otherwise it becomes more difficult for oncoming vehicles to see you.
- Obtain and read the service instructions carefully prior to installing the parts. Loose, worn, or damaged parts may cause serious injury to the rider. We strongly recommend only using genuine Shimano replacement parts.
- If you have any questions concerning your pedals, contact a professional dealer.
- Read these Technical Service Instructions carefully, and keep them in a safe place for later reference.

### NOTE:

- Check that there is no looseness in any joints or connections before riding the bicycle. (BB-FC, FC-PD)
- In addition, if pedaling performance does not feel normal, check this once more.
- Parts are not guaranteed against natural wear or deterioration resulting from normal use.
- For maximum performance we highly recommend Shimano lubricants and maintenance products.

SI-MX30B

**PD-MX30**

Pedals

## Technical Service Instructions

These service instructions are printed on recycled paper.

Please note: Specifications are subject to change for improvement without notice. (English)

**SHIMANO®**

SHIMANO AMERICAN CORPORATION  
One Holland, Irvine, California 92618, U.S.A. Phone: +1-949-951-5003

SHIMANO EUROPE HOLDING B.V.  
Industrieweg 24, 8071 CT Nunspeet, The Netherlands Phone: +31-341-272222

SHIMANO INC.  
3-77 Oimatsu-cho, Sakai, Osaka 590-8577, Japan

© Feb. 2004 by Shimano Inc. PIT. SZK. Printed in Japan

## Mounting the pedals on the crank arms

Use a 15 mm spanner to mount the pedals on the crank arms. The right pedal has a right-hand thread; the left pedal has a left-hand thread.

Pay attention to the mark  
R: right pedal  
L: left pedal

15 mm spanner

Tightening torque:  
35 N·m {304 in. lbs.} min.

## Pin maintenance

If the pins become worn or damaged, replace them with new pins.

Tightening torque:  
0.5 – 0.8 N·m {4.3 – 6.9 in. lbs.}

1.5 mm Allen key

Pin

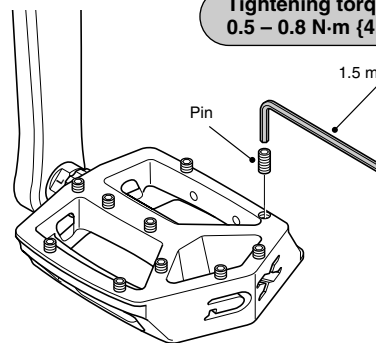

## Maintenance of the axle units

If you experience any trouble with the rotating parts of the pedal, the pedal may require adjustment. Obtain advice from a professional dealer.

## Mounting the reflectors (optional)

An optional reflector set is available. Please contact a professional dealer for details.